

INDEX OF SHEETS

SHEET NUMBER	DESCRIPTION
CIVIL	
C0.1	TITLE SHEET
C1.0-1.2	EXISTING CONDITIONS AND DEMOLITION PLANS
C2.0	PLEASURE POINT PARK PLAN
C2.1-2.11	PARKWAY SITE PLANS AND PROFILES
C3.0-3.11	PARKWAY SITE CROSS SECTIONS
C4.0-4.2	STRIPING AND SIGNAGE PLANS
C5.0	KEYNOTES & NOTES
C6.0	TYPICAL SECTIONS & CURB RAMP DETAILS
C6.1	STORM DRAIN OUTFALL PROFILES
C6.2	KEYNOTES & DETAILS
C6.3-6.4	RAISED PAVEMENT DETAILS
C7.0-7.2	EROSION CONTROL PLANS
C8.0-8.3	TRAFFIC CONTROL & STAGING AREA PLAN
LANDSCAPE	
L1.0-1.9	IRRIGATION PLANS
L1.10	IRRIGATION LEGEND AND NOTES
L1.11-1.13	IRRIGATION DETAILS
L1.14	IRRIGATION SCHEDULES
L2.0-2.9	PLANTING PLANS
L2.10	PLANTING LEGEND AND NOTES
L2.11-2.12	PLANTING DETAILS
L2.13-2.14	MATERIALS DETAILS
SIGNS & EXHIBITS	
SE1.0	TERRACE PLAN WITH FOSSIL PLACEMENT
SE2.0	TERRACE ELEVATIONS
SE3.0	TERRACE PLANS: ARTWORK
SE3.1	TERRACE ELEVATIONS: ARTWORK
SE3.2	TERRACE PLANS: FOSSILS
SE4.0	TERRACE SECTIONS & POUR DETAILS
SE5.0	MINOR INTERPRETIVE SIGN
SE6.0	TRAIL MARKERS
ARCHITECTURAL	
A1.1	BUILDING INFORMATION
A2.1	FLOOR PLAN, ROOF PLAN
A2.2	SCHEDULES
A3.1	EXTERIOR ELEVATIONS
A3.2	SECTIONS
A5.1	INTERIOR ELEVATIONS
A8.1	DOOR & LOUVER DETAILS
A8.2	ACCESSIBILITY DETAILS
A8.3	ROOF DETAILS
A8.4	WALL DETAILS
PLUMBING	
P0.1	PLUMBING FLOOR PLAN, LEGEND, CONNECTIONS/FIXTURE LIST
STRUCTURAL	
S1	FOUNDATION AND ROOF FRAMING
S2	GENERAL NOTES AND TYPICAL DETAILS
S3	DETAILS
S4	RETAINING WALL
S5	DETAILS
ELECTRICAL	
E0.1	SYMBOLS, ABBREVIATIONS & NOTES
E1.0	RESTROOM ELECTRICAL & PARTIAL SITE PLAN
E1.1-1.5	PARTIAL SITE PLAN
E1.6	SINGLE LINE DIAGRAM, DETAILS & T-24
E1.7	ELECTRICAL UTILITIES ANALYSIS

PROJECT BENCHMARK

ELEVATIONS SHOWN HEREON ARE BASED ON SANTA CRUZ COUNTY BENCHMARK #245 LOCATED 72 FEET SOUTH FROM THE CENTERLINE OF OPAL CLIFF DRIVE, 28 FEET EAST FROM THE CENTERLINE OF 41ST AVENUE AND 6 FEET WEST OF A 3 FOOT HIGH CYCLONE FENCE; A STANDARD CONCRETE MONUMENT WITH BRASS CAP; ELEVATION = 45.535 NGVD 29 (ADJUSTED)
ELEVATION = 48.274 NAVD 88 (CONVERTED)

PROJECT CONTROL

HORIZONTAL DATUM: CALIFORNIA STATE PLANE COORDINATE SYSTEM ZONE III, NAD83 (1991.35) CA HPGN

VERTICAL DATUM: NAVD88

PROJECT MAPPING AND SURVEY DATA WAS PROVIDED BY SANTA CRUZ COUNTY.

LEGEND

	NEW ASPHALT		PROPERTY BOUNDARY/ROW
	NEW CONCRETE		STREET CENTERLINE
	NEW DECOMPOSED GRANITE		SAFETY RAIL FENCE
	NEW CONCRETE TERRACES		SPLIT RAIL FENCE
	ASPHALT GRIND AND OVERLAY		SAWCUT LINE
			EXISTING WATER LINE
			EXISTING SANITARY SEWER LINE
			EXISTING GAS LINE
			EXISTING OVERHEAD POWER LINE

ABBREVIATIONS

AC	ASPHALT	GALV	GALVANIZED
APT	ANGLE POINT	GB	GRADE BREAK
BC	BEGIN CURVE	GRT	GRATE
BVC	BEGIN VERTICAL CURVE	HDPE	HIGH DENSITY POLYETHYLENE PIPE
BW	BACK OF WALKWAY	HP	HIGH POINT
CATV	CABLE TELEVISION	INV.	INVERT
CB	CATCH BASIN	LF	LINEAL FEET
CL	CENTERLINE	LP	LOW POINT
CMP	CORRUGATED METAL PIPE	LT.	LEFT
CONC.	CONCRETE	MAX.	MAXIMUM
CONST.	CONSTRUCT	MH	MANHOLE
CONT.	CONTINUOUS	MIN.	MINIMUM
DG	DECOMPOSED GRANITE	N	NEW
DIA.	DIAMETER	O.C.	ON CENTER
(E)	EXISTING	PRC	POINT OF REVERSE CURVE
E	ELECTRICAL	RC	RELATIVE COMPACTION
EC	END OF CURVE	RCP	REINFORCED CONCRETE PIPE
EP/EOP	EDGE OF PAVEMENT	ROW	RIGHT OF WAY
EVC	END VERTICAL CURVE	RT.	RIGHT
E.W.	EACH WAY	SCH	SCHEDULE
FOC	FACE OF CURB	SS	SANITARY SEWER
FIN	FINISH	SD	STORM DRAIN
FL	FLOWLINE	TC	TOP OF CURB
FS	FINISH SURFACE	TYP	TYPICAL
G	GAS	UG	UNDERGROUND UTILITY
		W	WATER

COUNTY OF SANTA CRUZ
DEPARTMENT OF PUBLIC WORKS

PROJECT PLANS FOR CONSTRUCTION OF A
REDEVELOPMENT AGENCY FUNDED PROJECT
EAST CLIFF DRIVE PARKWAY PROJECT
32nd Avenue to 41st Avenue

COASTAL COMMISSION PERMIT NUMBER A-3-SCO-07-015, CDP 3-07-019 AND SANTA CRUZ COUNTY PERMIT NUMBER 00-0797

FOR USE IN CONJUNCTION WITH THE "SPECIFICATIONS FOR EAST CLIFF DRIVE PARKWAY PROJECT" AND THE STANDARD DETAILS OF THE COUNTY OF SANTA CRUZ AND THE STANDARD PLANS AND STANDARD SPECIFICATIONS OF THE STATE OF CALIFORNIA DEPARTMENT OF TRANSPORTATION, DATED MAY 2006.

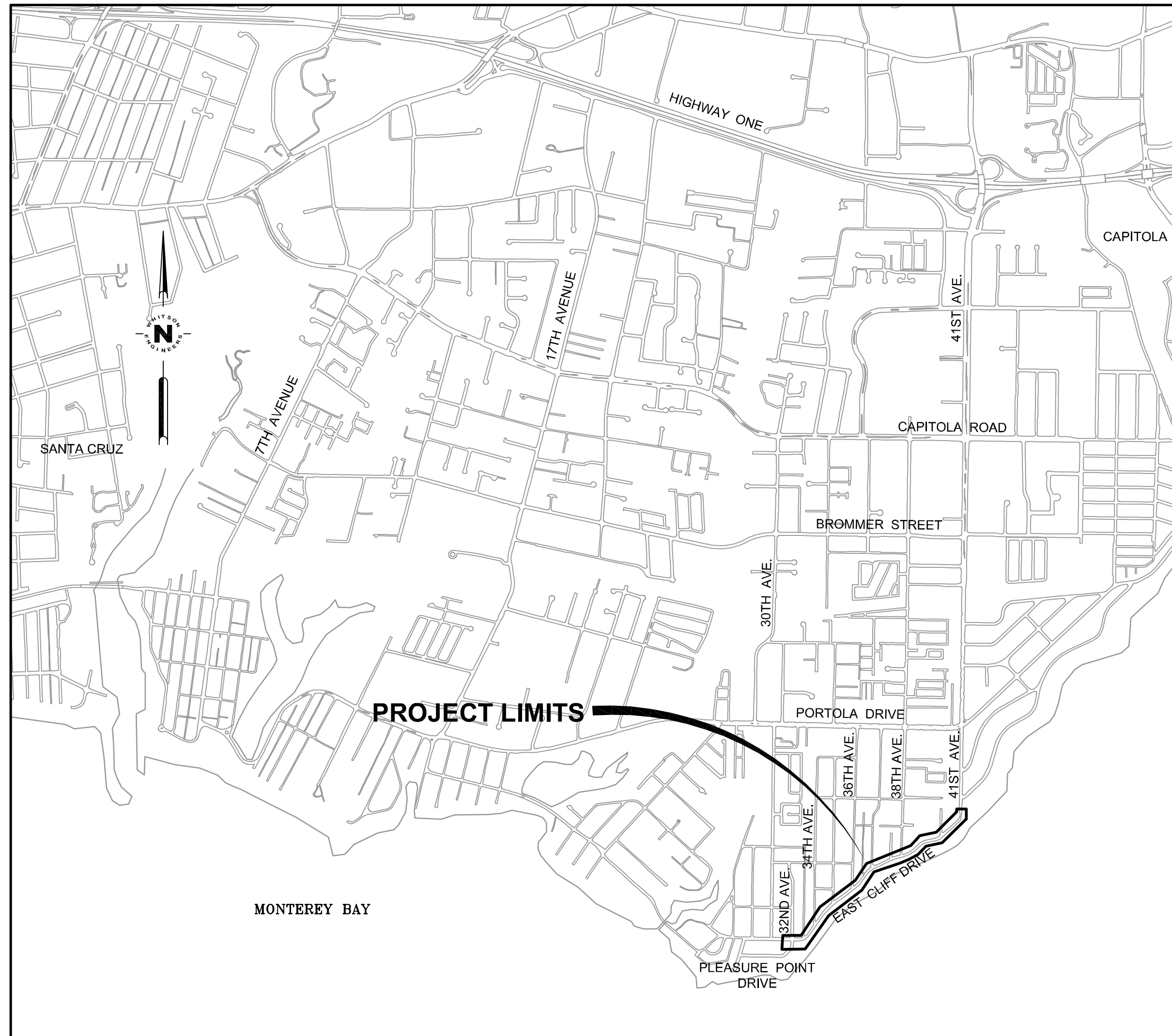

VICINITY MAP & PROJECT LIMITS

NOT TO SCALE

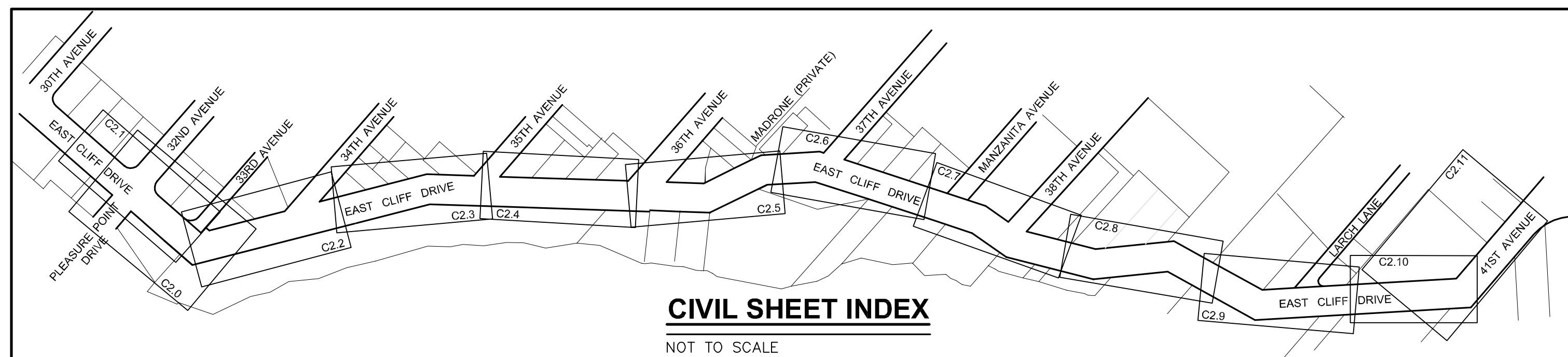

CIVIL SHEET INDEX

NOT TO SCALE

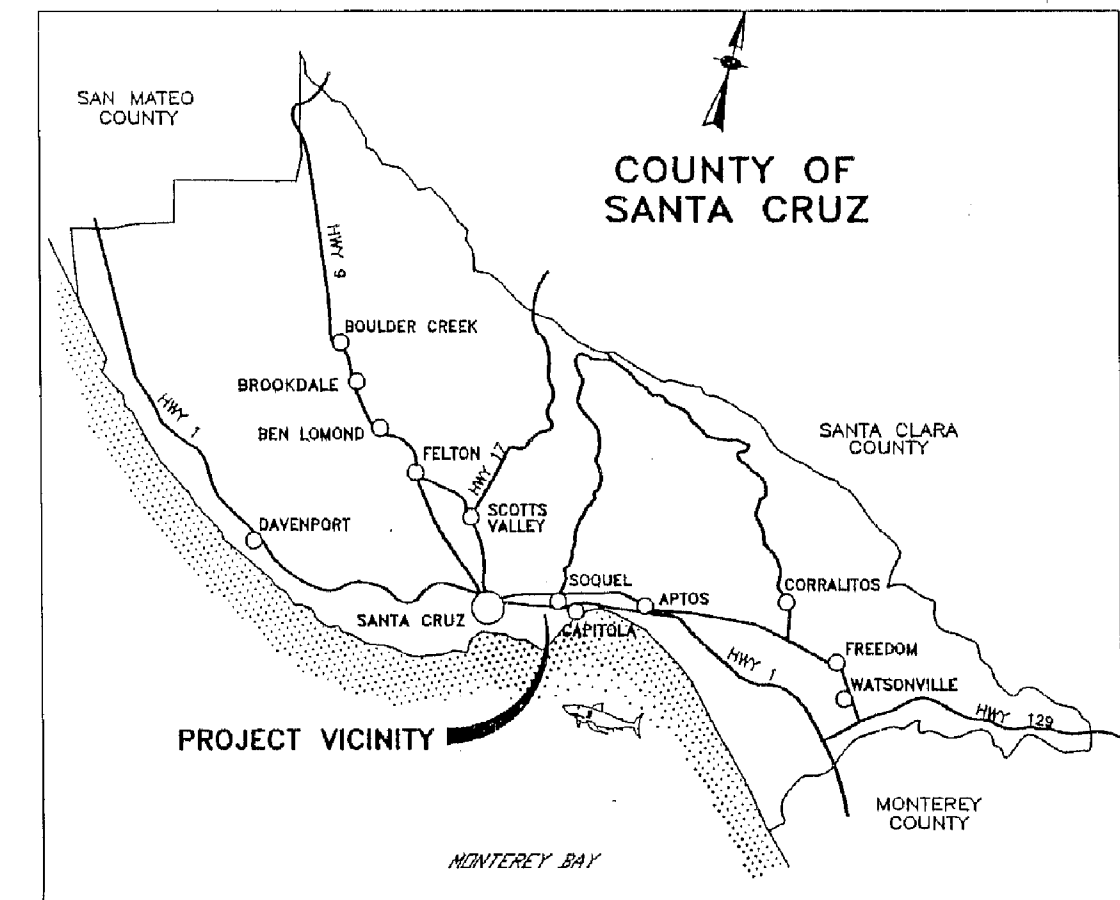

LOCATION MAP

PROJECT TEAM

- SANTA CRUZ REDEVELOPMENT AGENCY
701 OCEAN STREET, ROOM 510
SANTA CRUZ, CA 95060
TEL 831-454-2280
FAX 831-454-3420
CONTACT: MELISSA ALLEN, PROJECT MANAGER
- COUNTY OF SANTA CRUZ,
DEPARTMENT OF PUBLIC WORKS
701 OCEAN STREET, ROOM 410
SANTA CRUZ, CA 95060
TEL 831-454-2160
FAX 831-454-2385
CONTACT: JOEL LACAGNIN, SENIOR CIVIL ENGINEER
- COUNTY OF SANTA CRUZ DEPARTMENT OF PARKS,
OPEN SPACE AND CULTURAL SERVICES
979 17TH AVENUE
SANTA CRUZ, CA 95062
TEL 831-454-7901
FAX 831-454-7940
CONTACT: JOE SCHULTZ, DIRECTOR
- CIVIL ENGINEER-PROJECT MANAGEMENT:
WHITSON ENGINEERS
2425 PORTER STREET, SUITE 2
SOQUEL, CA 95073
TEL 831-464-9363
FAX 831-464-2316
CONTACT: RODNEY TRUJILLO, P.E., PROJECT MANAGER
- LANDSCAPE ARCHITECT:
JONI L. JANECKI & ASSOCIATES, INC.
515 SWIFT STREET
SANTA CRUZ, 95060
TEL 423-6040
FAX 423-6054
CONTACT: JONI JANECKI, ASLA, PRESIDENT
- NATIVE PLANT SPECIALIST:
SUNSET COAST NURSERY
2745 TIERRA WAY
AROMAS, CA 95004
TEL 831-726-1672
FAX 831-726-1672
CONTACT: PATTI KREIBERG, PROJECT MANAGER
- INTERPRETIVE DESIGNER:
LESLIE STONE ASSOCIATES
104 CALEDONIA STREET
SAUSALITO, CA 94965
TEL 415-332-3306
FAX 415-332-3309
CONTACT: LESLIE STONE, PRESIDENT
- ARCHITECT:
WALD, RUHNKE & DOST ARCHITECTS, LLP
701 MISSION STREET
SANTA CRUZ, CA 95060
TEL 831-421-0468
FAX 831-421-0673
CONTACT: DAVID RHODES, AIA, PROJECT MANAGER
- MECHANICAL ENGINEER:
AXIOM ENGINEERS, CONSULTING MECHANICAL ENGINEERS
4605 WEST WALNUT STREET
SOQUEL, CA 95073
TEL 831-464-4320
FAX 831-464-4323
CONTACT: JEFF MEADE, P.E., PROJECT MANAGER
- STRUCTURAL ENGINEER:
STREETER GROUP, INC
2571 MAIN STREET, SUITE C
SOQUEL, CA 95073
TEL 831-477-1781
FAX 831-477-1751
CONTACT: BRAD STREETER, S.E., PRINCIPAL ENGINEER
- ELECTRICAL ENGINEER:
AURUM CONSULTING ENGINEERS MONTEREY BAY, INC.
60 GARDEN ROAD, SUITE 210
MONTEREY, CA 93940
TEL 831-646-3330
FAX 831-646-3336
CONTACT: CHARLES DENLEY, P.E., PROJECT MANAGER

REDEVELOPMENT ENGINEER
REGISTERED CIVIL ENGINEER

ASSISTANT DIRECTOR OF PUBLIC WORKS
REGISTERED CIVIL ENGINEER

DIRECTOR OF PUBLIC WORKS
REGISTERED CIVIL ENGINEER

CHAIR, BOARD OF SUPERVISORS

MARCH 8, 2011
PLANS APPROVAL DATE

APRIL 14, 2011
BIDS OPEN:

WHITSON ENGINEERS
2425 Porter Street • Suite 2 • Soquel, CA 95073
831 464-9363 • Fax 831 464-2316
CIVIL ENGINEERING • LAND SURVEYING • PROJECT MANAGEMENT



County of Santa Cruz
Department of Public Works
701 Ocean St., Rm 410
Santa Cruz, CA 95060-4000
Phone: (831) 454-2160
Fax: (831) 454-2385

TITLE SHEET
EAST CLIFF DRIVE PARKWAY PROJECT
32nd AVENUE TO 41st AVENUE
County of Santa Cruz

REV	BY	DATE	DESCRIPTION
1	A	03/22/10	75% SUBMITTAL
2	A	10/08/10	95% SUBMITTAL
3	A	07/12/11	BID SET

DATE: SEPTEMBER 2010
SCALE: AS NOTED
DESIGNED BY: MS/RT
DRAFTED BY: RT/SG
CHECKED BY: KW
JOB NO.: 2280.01
FILE: Civil Plan.dwg

C0.1